

IDGRAM

NØVØ - P4H7

PAGE 1:  
JASON:

NØVØ - P4H7

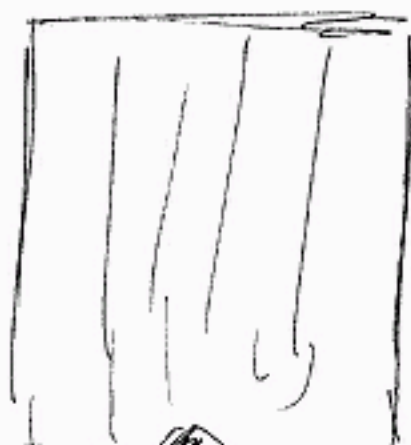

Stop

NØVØ-PUH7

NØVØ-PUH7

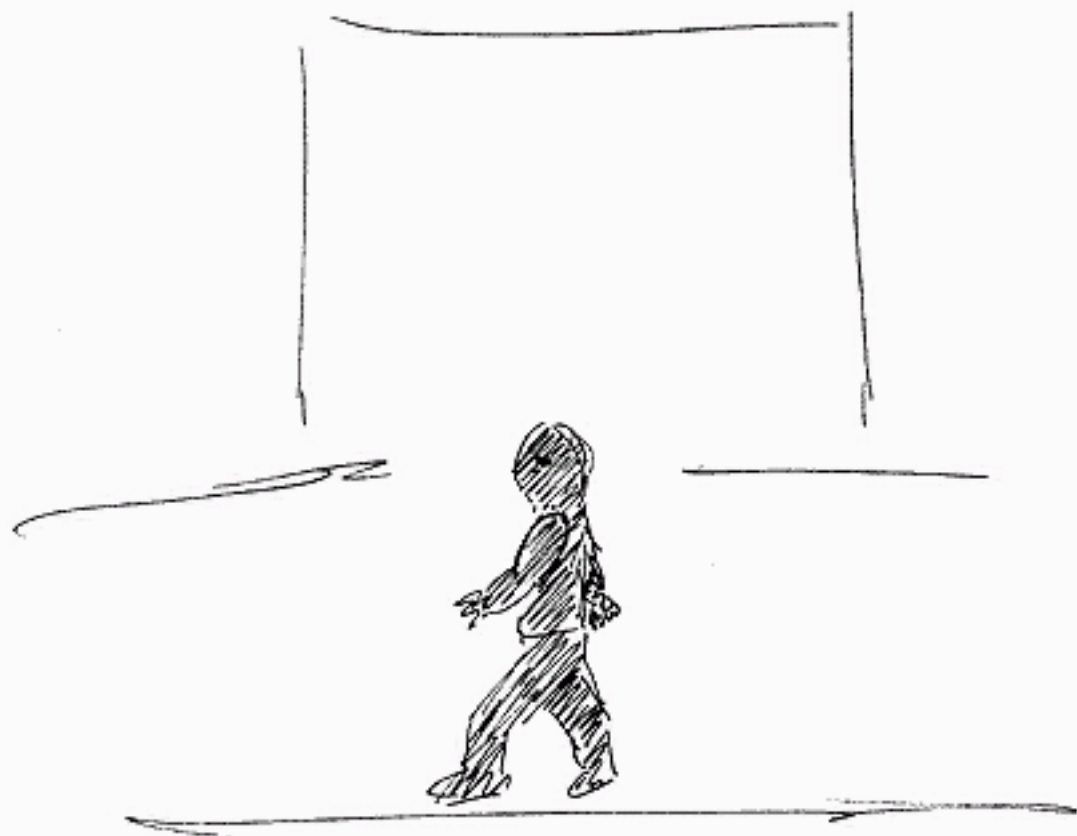

Shop

IDEGRAM

PAGE 3:

JANU:

NØVØ - P4H7

NØVØ - P4H7

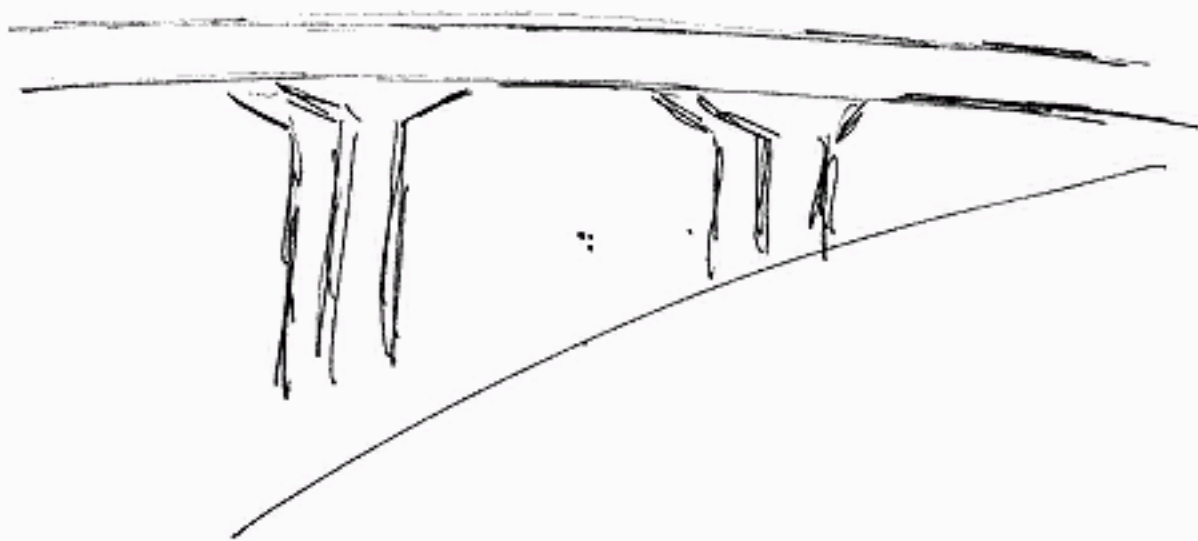

SKS

NØVØ - P4H7

NØVØ - P4H7

PL: Complex  
B: Hard  
I: Manmade  
A: Dynamic

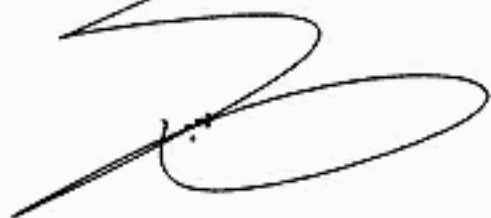

Stop

NØVØ - P4H7

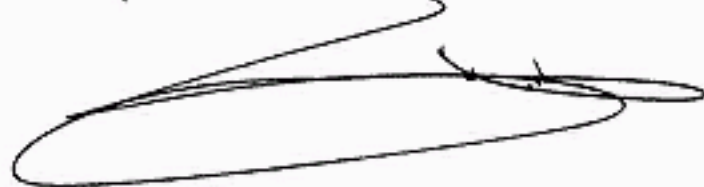

PL: Complex  
B: Hard  
I: Manmade  
A: Static



Stop

NØVØ - P4H7





PL: Complex  
B: Hard  
I: Manmade  
A: Static

Stop

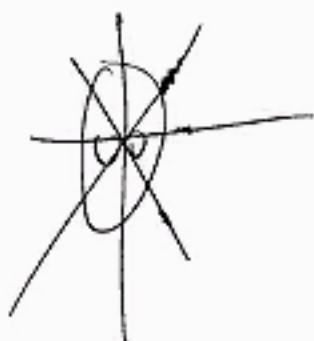
	Sights	Sounds	smell Taste	temps	texture
Colors Red Orange Yellow Black	 (hand w/ rings)	voices	damp musky	Cool	hard
Brite Med		rumbly jangly	dusty	Warm	hard
Focus Med		horn	thick air dusty	warm	hard
			stop		



	Sights	Sounds	smell taste	temps	texture	P
Carous Black Blue Yellow		Voices	cologne	warm	soft	people
Brite Med		zzzz	'	heat	hard	object
Focus Med		running water footsteps	rock	warm	hard	bridge
			slap			

## SZ PHONICS

A: Anvil, Angst, anger, annatoli, anchovy, all, advent

E: evolve, earnest, equipt, entrance, exit, dead

I: inside, involvement, Italian, internal.

O: mob, moon, over, dropped, enclosed

U: underneath, underwater, ue, uelenti, ulenti, queer, quit

Harold  
(Big) Bobby



lou  
Jimmy

S3

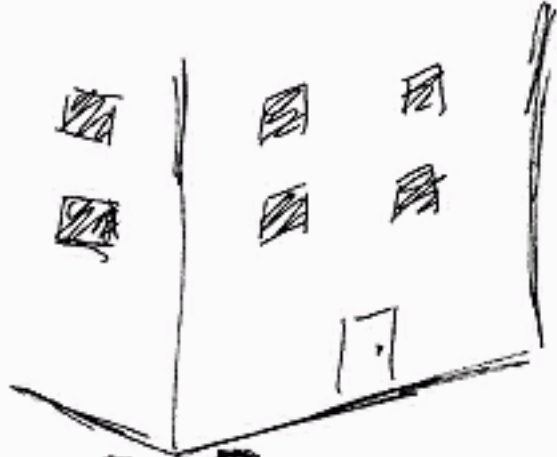

voices



zzzz

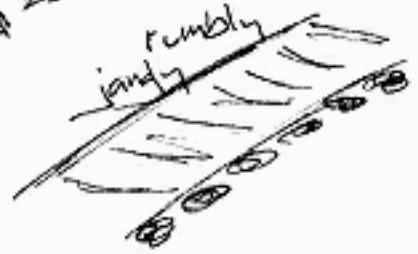

janitor rumbly

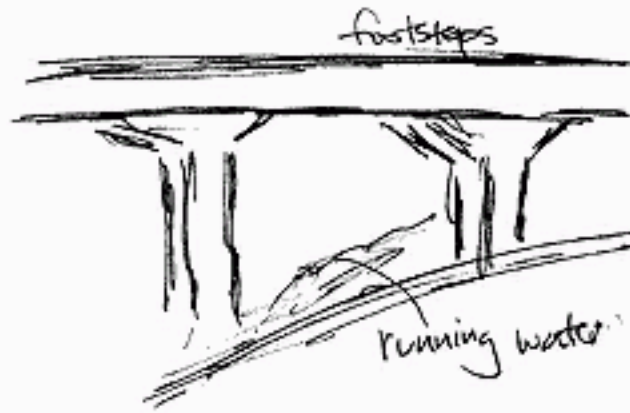

footsteps

running water



# CASCADE

LAND 1 AIR \_\_\_\_\_ WATER 1 STRUCTURE 3

ENERGY \_\_\_\_\_ OBSTACLE \_\_\_\_\_

LIFE: VEG: low  
LIFE: HUMAN: multiple  
LIFE: \_\_\_\_\_

## BLACKBOARD

LAND 1

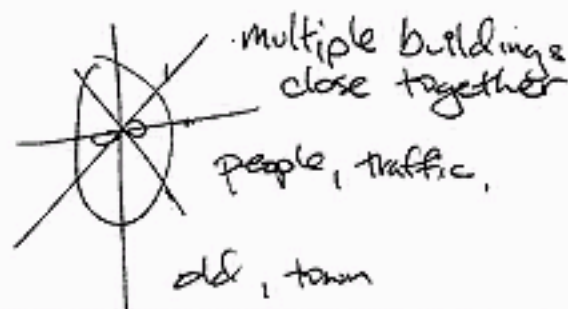

## BLACKBOARD

WATER 1

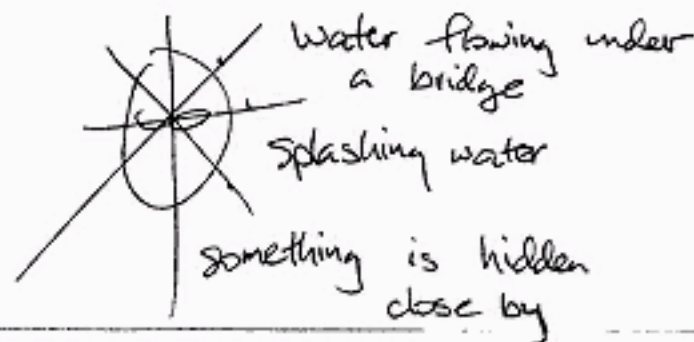

CASCADE

BLACKBOARD

Structure 1

inside: fancy, plush  
air conditioned

(New York)

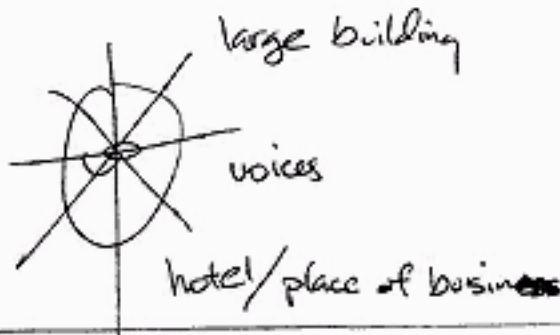

BLACKBOARD

Structure 2

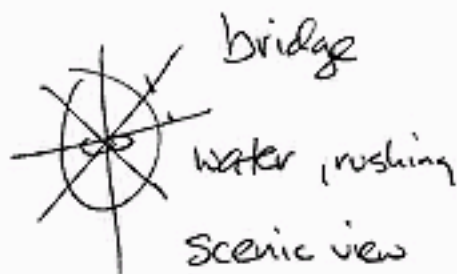

BLACKBOARD

HUMAN

(they have  
something  
to hide)

secret  
(Italian) (mafia)

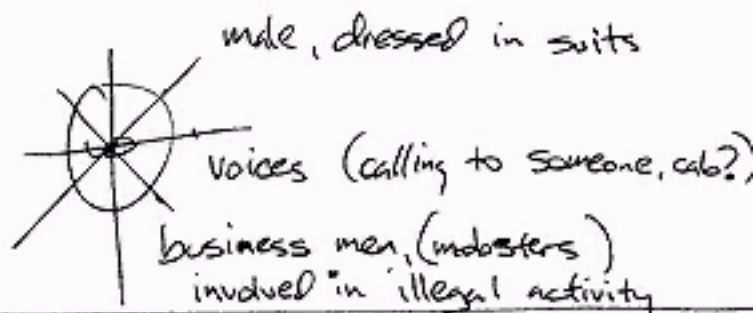

LAND 1

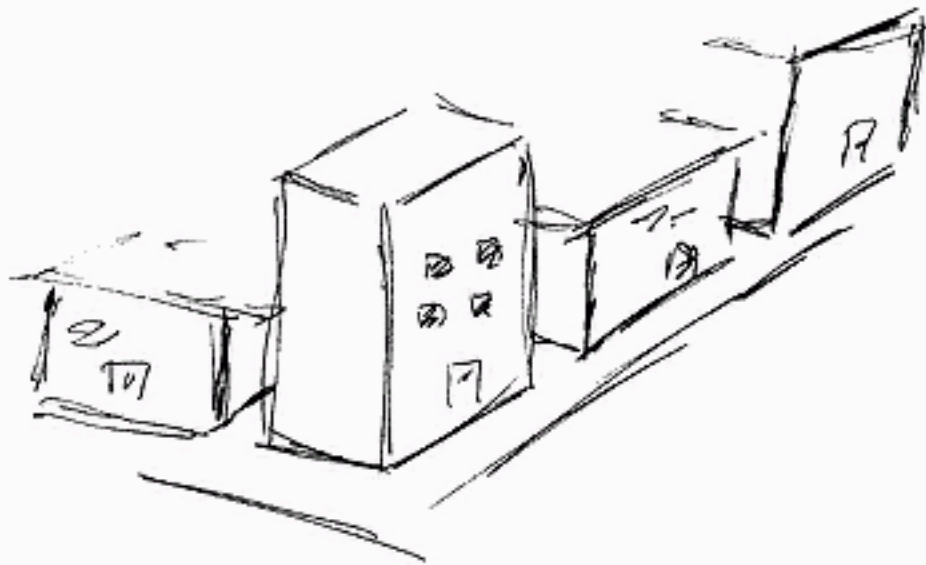

...

Water 1

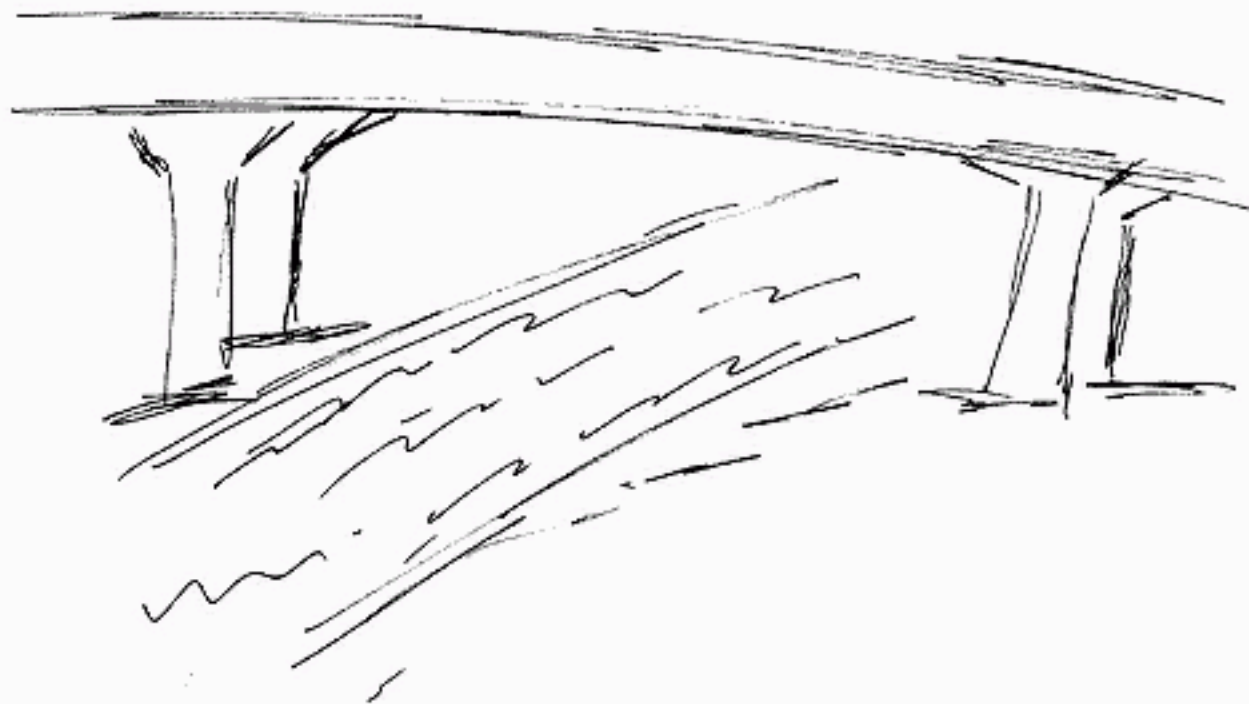

Structure 1

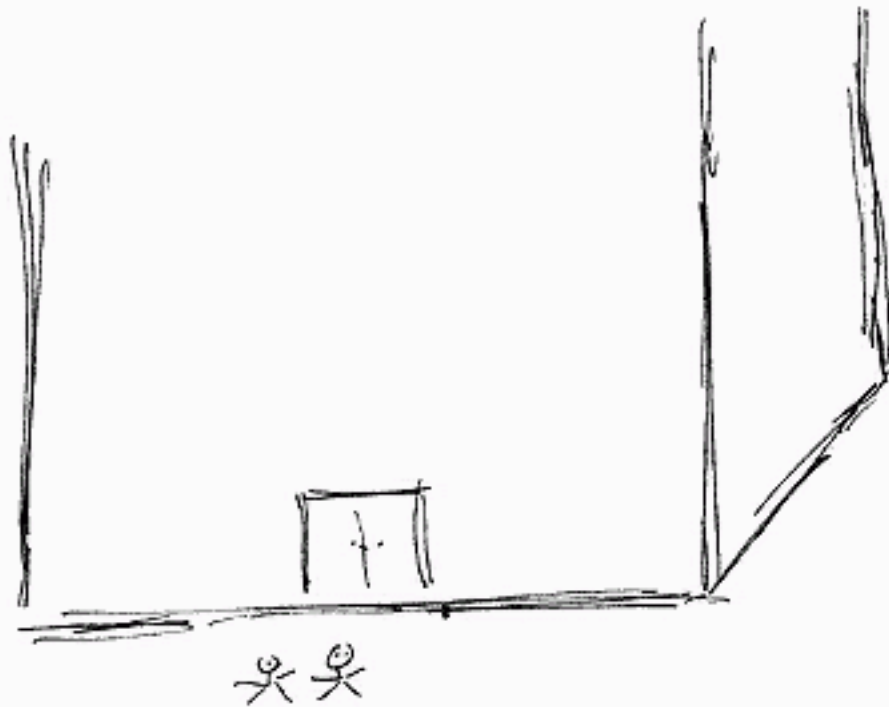

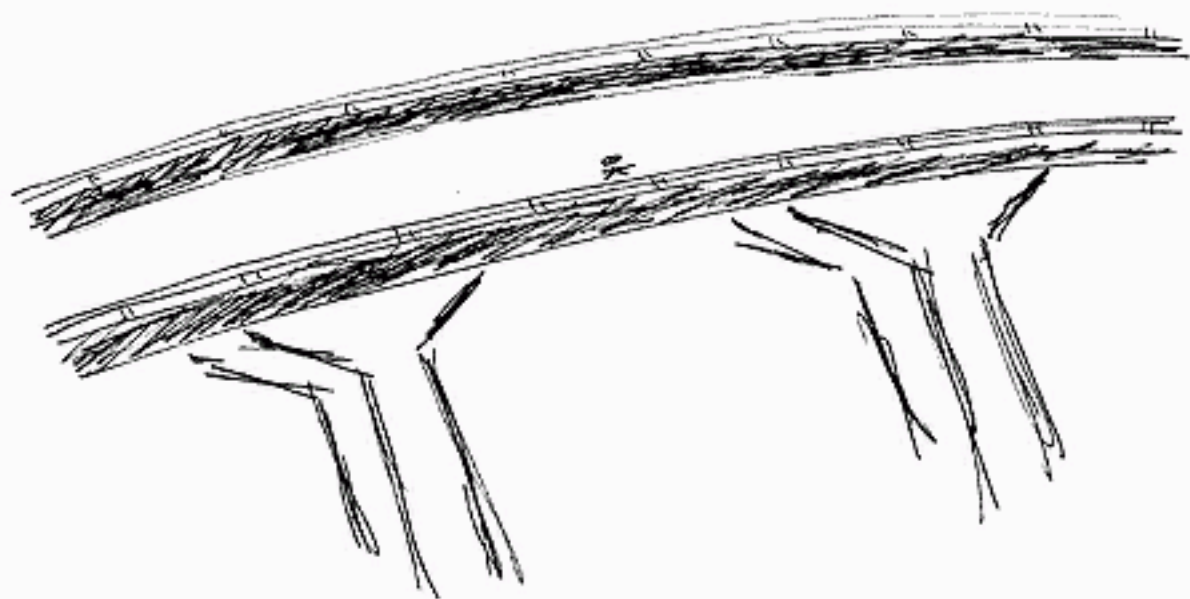

HUMAN



DESCRIBE LANDSCAPE: ROLLING HILLS, SOME TREES, OPEN SPACE, BUILDING(S) IN THE DISTANCE. DUSTY, DIRT,

DESCRIBE STRUCTURES: TALL BUILDING, RECTANGULAR SHAPE, LOTS OF WINDOWS, BUSINESS, OFFICE LIKE BUILDING, LOTS OF GLASS ASSOCIATED WITH THIS BUILDING.

DESCRIBE BRIDGE: LARGE BRIDGE, HIGH UP, CONCRETE, CAN'T SEE ANY VEHICLES, THERE ARE PEOPLE ON IT, LOOKING OVER, WATER BELOW UNDER BRIDGE,

OTHER INFO: STRUCTURE IS FANCY, LIKE A HOTEL, VEHICLES CAN DRIVE UP TO ENTRANCE, SEMI-CIRCLE DRIVEWAY.



DESCRIBE PEOPLE: THEY ARE WEARING SUITS,  
ONE IS WEARING NICE CLOTHES, HOLDING  
BRIEF CASE, ANOTHER PERSON CLOSE BY  
SEEMS LIKE A BODYGUARD, THEY GET  
IN TO A CAR, THEY HAVE TO GET  
SOMEPLACE, THEY SPEAK ENGLISH  
WITH AN ACCENT, (FOREIGN?)

DESCRIBE "SECRET": IT IS RELATED TO 2 PEOPLE.  
THEY ARE HIDING SOMETHING, IT INVOLVES  
MONEY, THERE WAS AN ACCIDENT OR  
MISHAP, PEOPLE MAY HAVE BEEN INJURED.  
(OR KILLED)  
THEY WORK FOR A LARGER GROUP,

ADDITIONAL INFO: NO ADDITIONAL INFO.

